



41 King Edward Avenue, Glossop, Derbyshire, SK13 7QZ

A refurbished semi-detached family house, only a short walk from Glossop town centre and railway station, offered for sale with No Onward Chain. With brand new front windows, front door and patio doors, new carpets throughout and redecorated, the living space briefly comprises of an entrance porch, entrance hall, front lounge, fitted dining kitchen, three first floor bedrooms and a bathroom with shower. Front and rear gardens. Energy Rating D

£220,000

Viewing arrangements

Viewing strictly by appointment through the agent

44 High Street West, Glossop, Derbyshire, SK13 8BH 01457 858888

GROUND FLOOR

Front Porch

New pvc double glazed front door, gas and electric meter cupboard and door through to:

Entrance Hall

Central heating radiator, spindled stairs leading to the first floor and doors to:

Lounge

13'0 x 10'1 (max)

New pvc double glazed front window and central heating radiator.

Dining Kitchen

16'7 x 11'3

A range of fitted shaker style kitchen units finished in cream comprising base cupboards and drawers, built-in electric oven,

plumbing for an automatic washing machine, work tops over with an inset single drainer stainless steel sink unit and mixer tap, gas hob and filter hood, matching wall cupboards, pvc double glazed rear window, central heating radiator and new pvc double glazed patio doors leading out to the rear garden.

FIRST FLOOR

Landing

Pvc double glazed side window, cupboard housing the Baxi gas fired central heating boiler, access to the loft space and doors leading off to:

Bedroom One

12'2 x 10'1

New pvc double glazed front window and central heating radiator.

Bedroom Two

10'2 x 10'1

Pvc double glazed rear window and central heating radiator.

Bedroom Three

8'10 x 6'3 (less bulkhead)

New pvc double glazed front window and central heating radiator.

Bathroom

A white suite including a panelled bath with Triton electric shower over and folding shower screen, pedestal wash hand basin and close coupled wc, pvc double glazed rear window and central heating radiator.

OUTSIDE

Gardens

The property stands on a corner with a fenced front garden and a lower maintenance flagged rear garden.

Our ref: Cms/cms/0912/25

Agents Notes - HMRC Directive

To be able to sell or purchase a property in the United Kingdom all agents have a legal requirement to conduct Identity checks on all customers involved in the transaction to fulfil their obligations under Anti Money Laundering regulations. We outsource this check to a third party and a charge will apply. Ask the branch for further details.

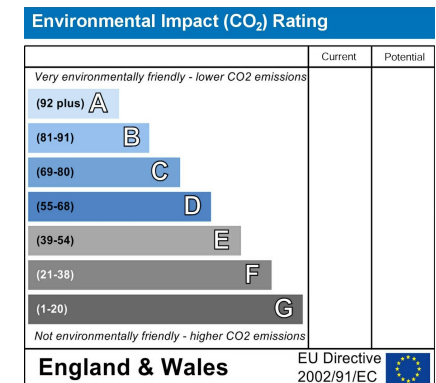
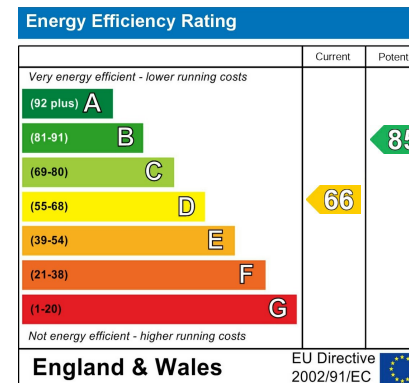



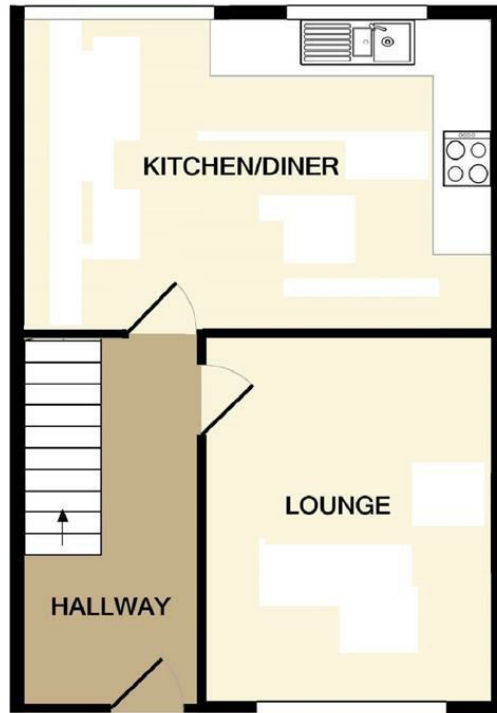

GROUND FLOOR

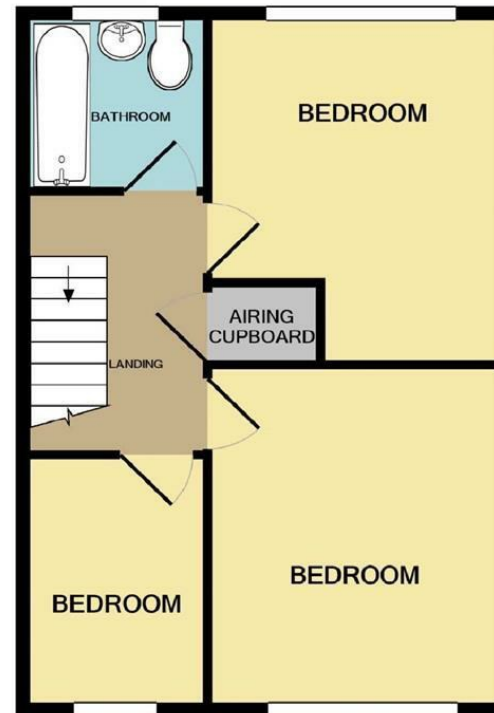

1ST FLOOR

Whilst every attempt has been made to ensure the accuracy of the floor plan contained here, measurements of doors, windows, rooms and any other items are approximate and no responsibility is taken for any error, omission, or mis-statement. This plan is for illustrative purposes only and should be used as such by any prospective purchaser. The services, systems and appliances shown have not been tested and no guarantee as to their operability or efficiency can be given
 Made with Metropix ©2021



These particulars are believed to be accurate but they are not guaranteed and do not form a contract. Neither Jordan Fishwick nor the vendor or lessor accept any responsibility in respect of these particulars, which are not intended to be statements or representations of fact and any intending purchaser or lessee must satisfy himself by inspection or otherwise as to the correctness of each of the statements contained in these particulars. Any floorplans on this brochure are for illustrative purposes only and are not necessarily to scale.

Offices at: Chorlton, Didsbury, Disley, Hale, Glossop, Macclesfield, Manchester Deansgate, Manchester Whitworth Street, New Mills, Sale, Wilmslow and Withington

44 High Street West, Glossop, Derbyshire, SK13 8BH

01457 858888

glossop@jordanfishwick.co.uk
 www.jordanfishwick.co.uk

